

PROPOSED SITE PLAN OF SCHOOL

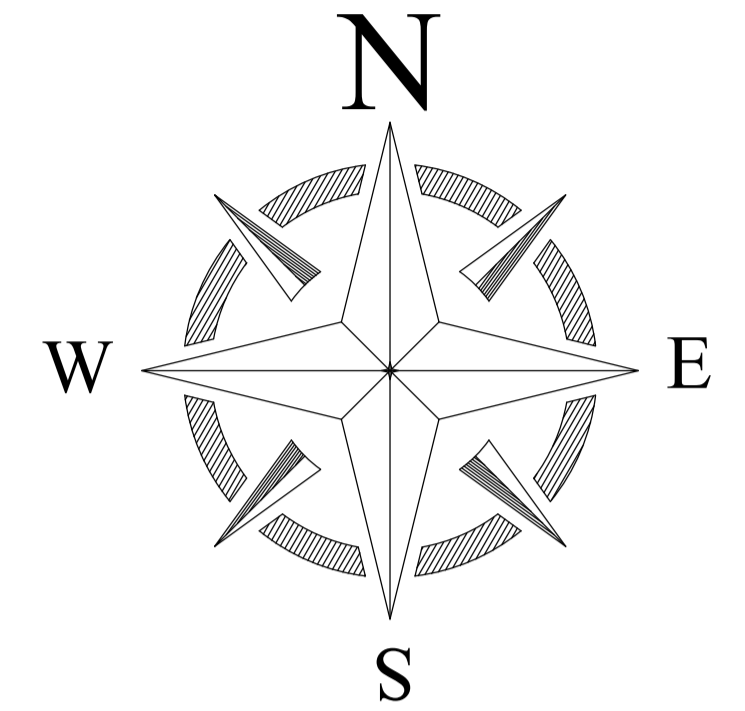

BLOCK NO	BLOCK NAME	AREA(In m)	TYPE
1	BLOCK - A	543.9	G. FLOOR
2	BLOCK - A1	123.5	G. FLOOR
3	BLOCK - B	290.5	G. FLOOR
4	BLOCK - C	226.4	G. FLOOR
5	OFFICE	146.5	G. FLOOR
6	LAB	166.6	G. FLOOR
7	TOILET 1	82.6	G. FLOOR
8	TOILET 2	17.3	G. FLOOR

CONSULTANT :

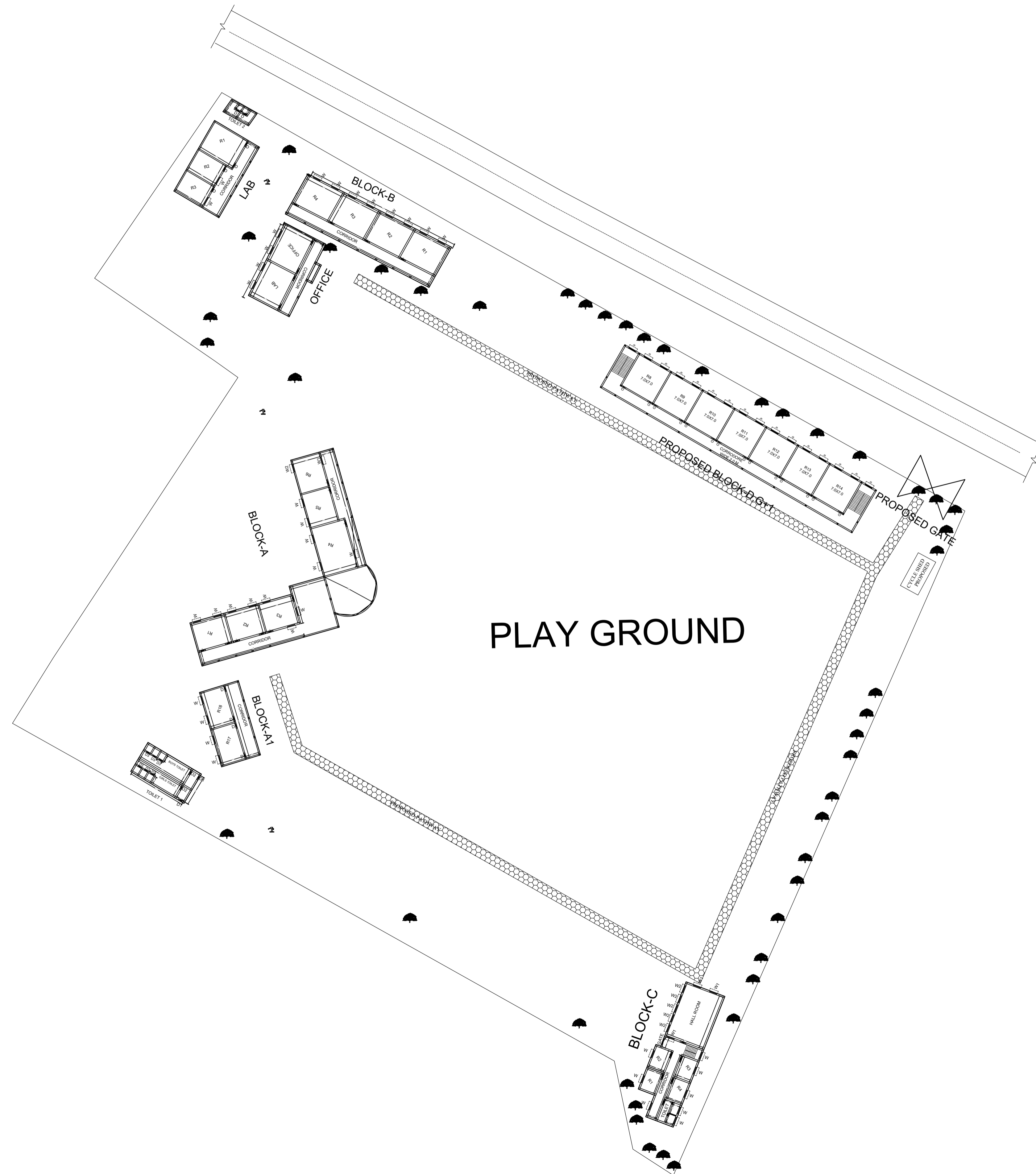

MaRS Planning & Engineering Services Pvt. Ltd.
 287/C Yash Padm Beside Hill Top Motors Ashok Nagar,
 Ranchi- 834002, Jharkhand, India.
Jharkhand@marsconsultancy.com

TITLE : - HIGH SCHOOL, BISHNUGARH

BLOCK : BISHNUGARH

FORWARDED BY : MaRS