

PROPOSED SITE PLAN OF SCHOOL

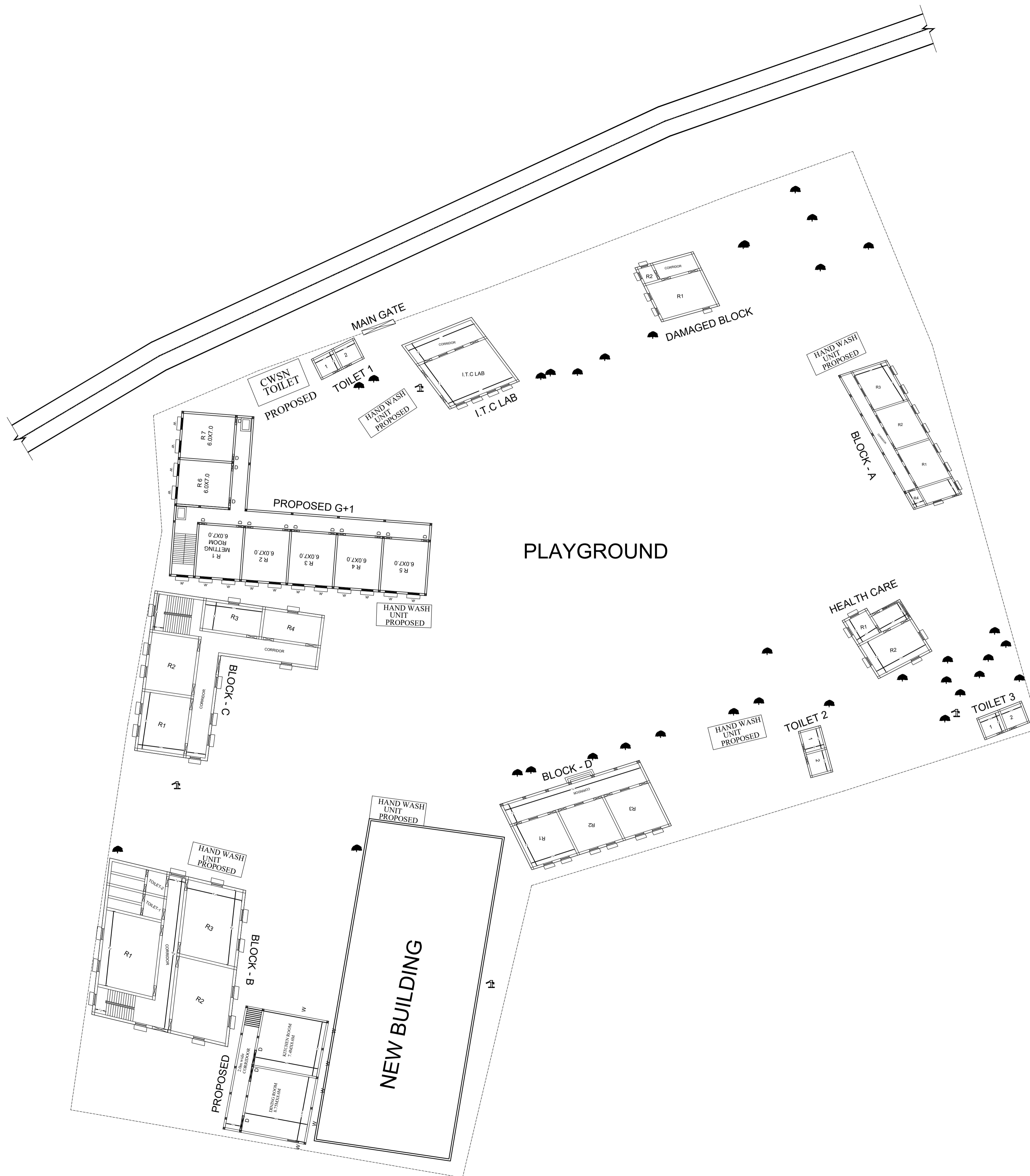
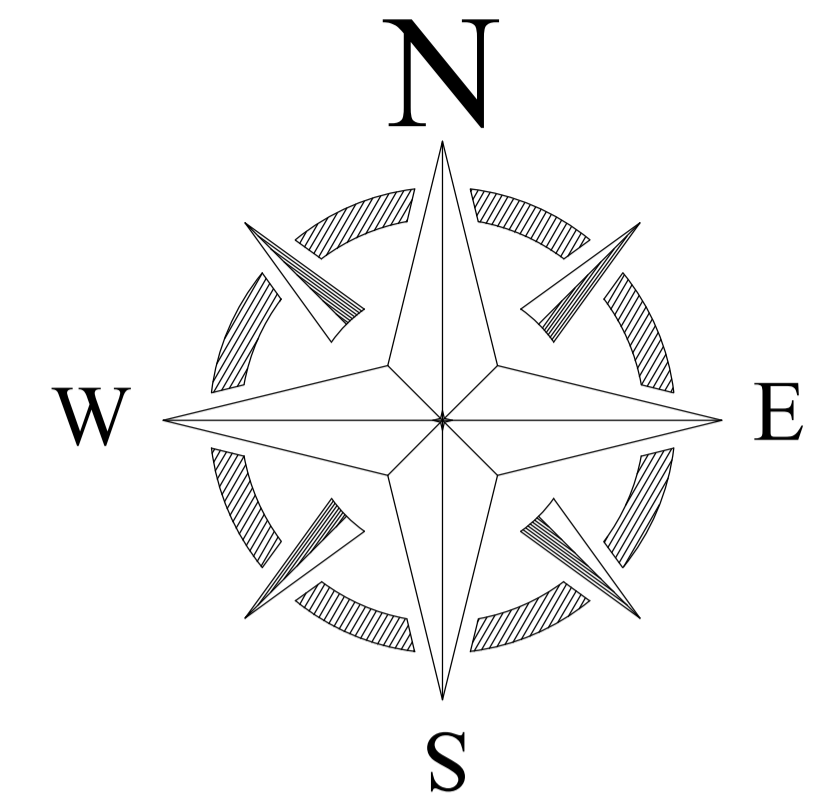

TOTAL LAND AREA-11854.9M

BLOCK NO	BLOCK NAME	AREA(In m)	TYPE
1	BLOCK - A	138.8	G. FLOOR
2	BLOCK - B	523.6	G+1 FLOOR
3	BLOCK - C	316.3	G. FLOOR
4	BLOCK - D	191.4	G. FLOOR
5	I.T.C LAB	105.6	G. FLOOR
6	DAMAGED BLOCK	65.1	G. FLOOR
7	HEALTH CARE	70.4	G. FLOOR
8	TOILET 1	20.1	G. FLOOR
9	TOILET 2	20.1	G. FLOOR
10	TOILET 3	20.1	G. FLOOR

CONSULTANT :



MaRS Planning & Engineering Services Pvt. Ltd.
 287/C Yash Padm Beside Hill Top Motors Ashok Nagar,
 Ranchi- 834002, Jharkhand, India.
Jharkhand@marsconsultancy.com

TITLE : - K.B.S.S.+2HIGH SCHOOL CHOUPARAN

BLOCK : CHOUPARAN

FORWARDED BY : MaRS