

PROPOSED SITE PLAN OF SCHOOL

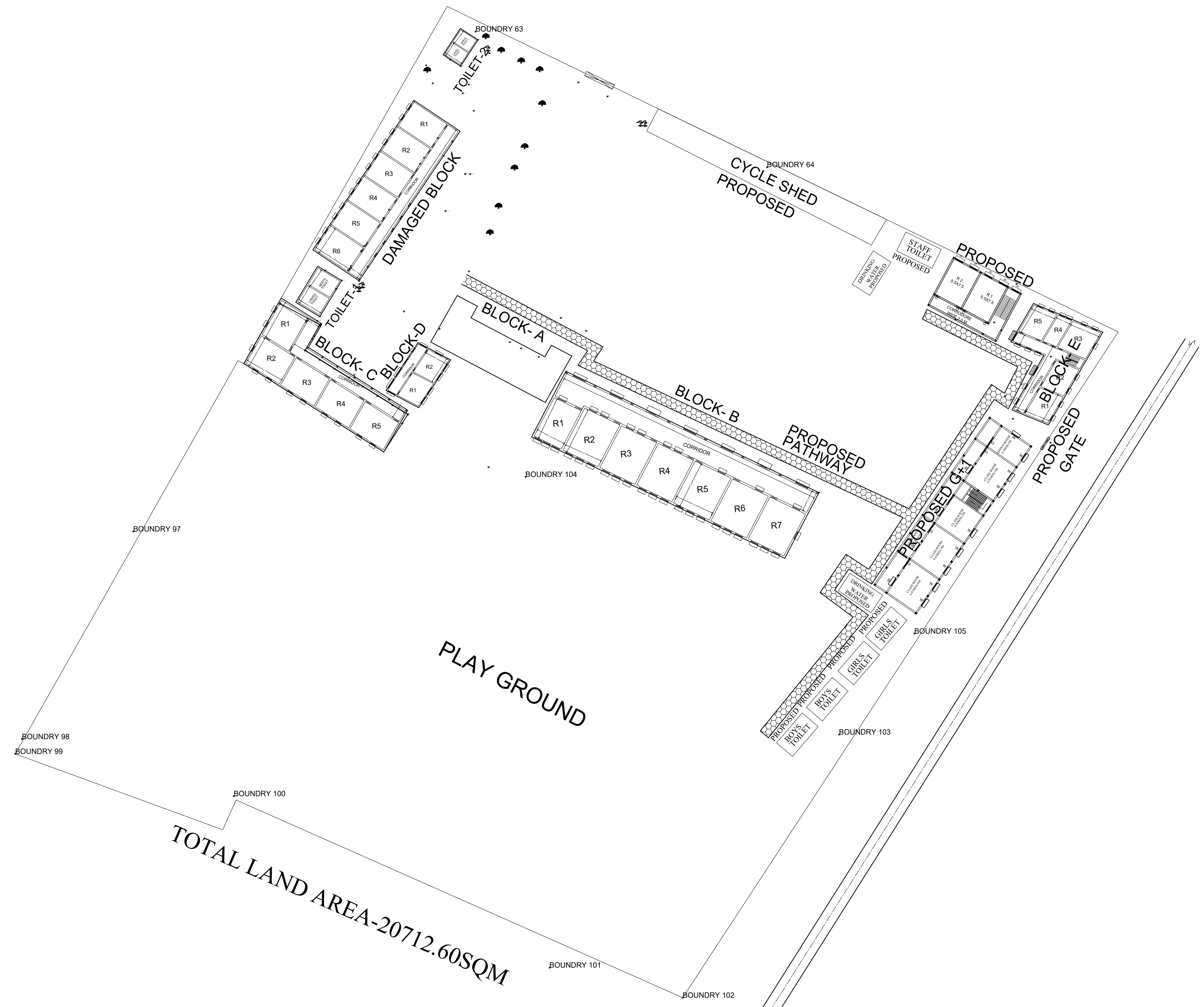
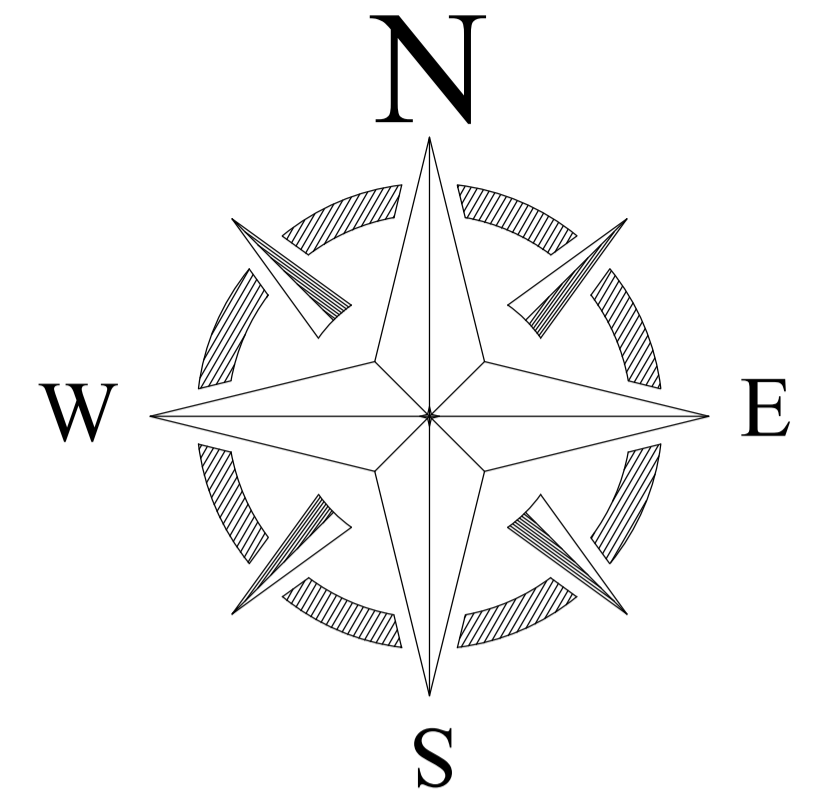

TOTAL LAND AREA-20712.60SQM

PROPOSED DRAWING

LEGENDS

BLOCK NO	BLOCK NAME	AREA(In SQM)	TYPE
1	BLOCK - A	298.00	G. FLOOR
2	BLOCK - B	527.80	G. FLOOR
3	BLOCK - C	353.80	G. FLOOR
4	BLOCK - D	143.80	G. FLOOR
5	BLOCK - E	561.00	G + 1
6	DAMAGED BLOCK	490.80	G. FLOOR
7	TOILET-1	26.60	G. FLOOR
8	TOILET-2	26.60	G. FLOOR

CONSULTANT :



MaRS Planning & Engineering Services Pvt. Ltd.
 287/C Yash Padm Beside Hill Top Motors Ashok Nagar,
 Ranchi- 834002, Jharkhand, India.
Jharkhand@marsconsultancy.com

TITLE : - K.N.+2 HIGH SCHOOL ICHAK

BLOCK : ICHAK

FORWARDED BY : MaRS