

# PROPOSED SITE PLAN OF SCHOOL

## SECONDARY SECTION

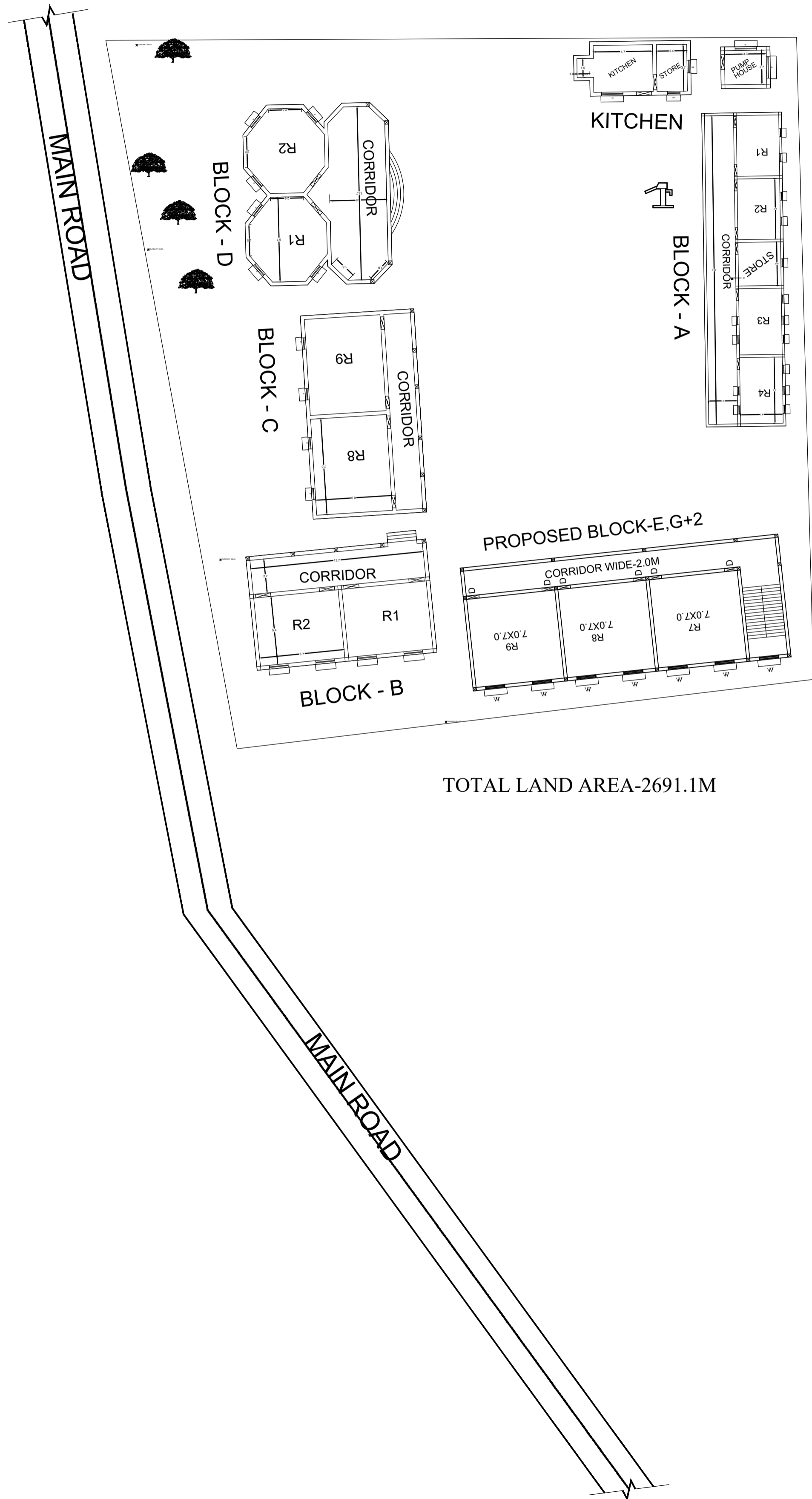

## HIGHER SECTION

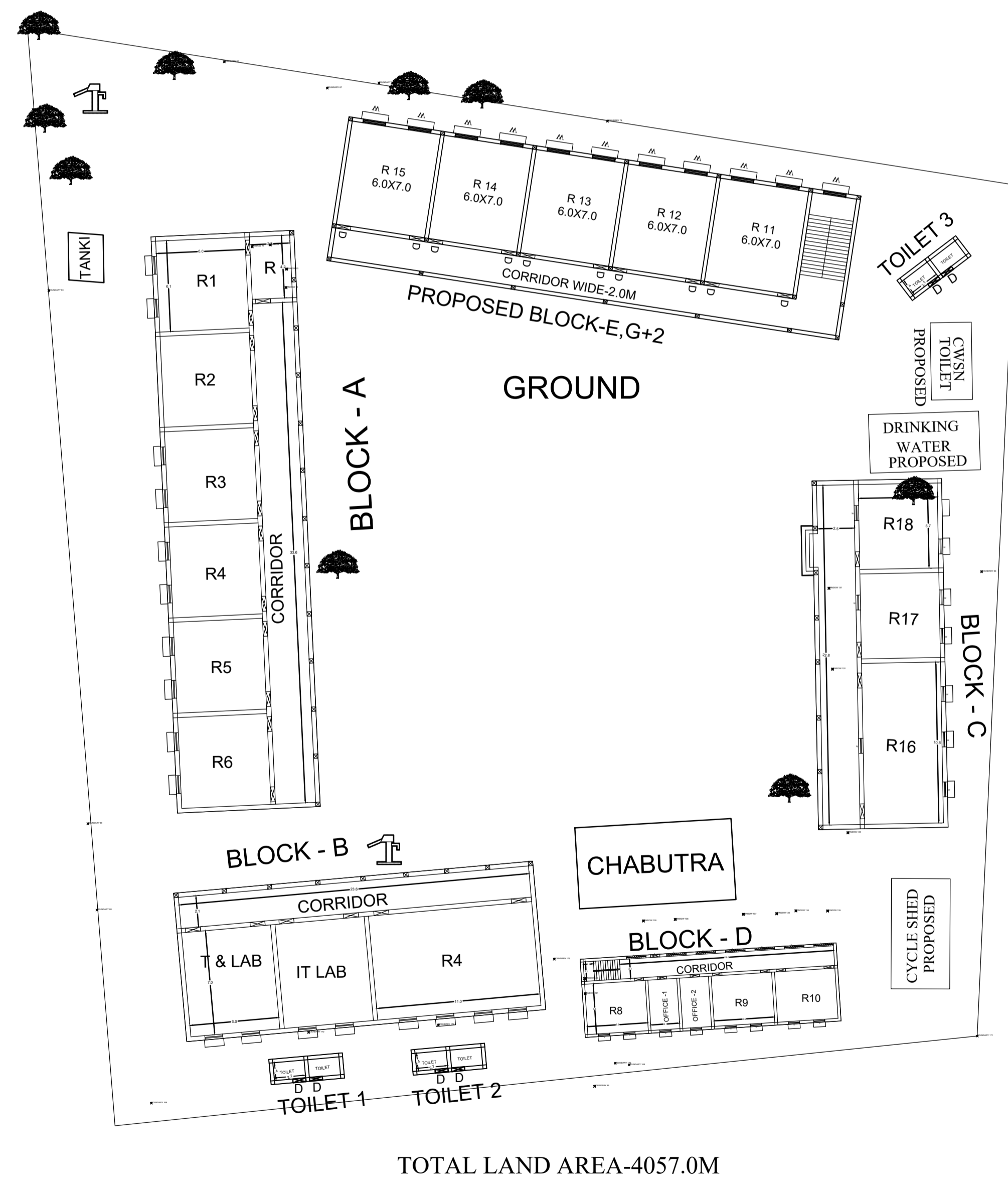

SECOND FLOOR

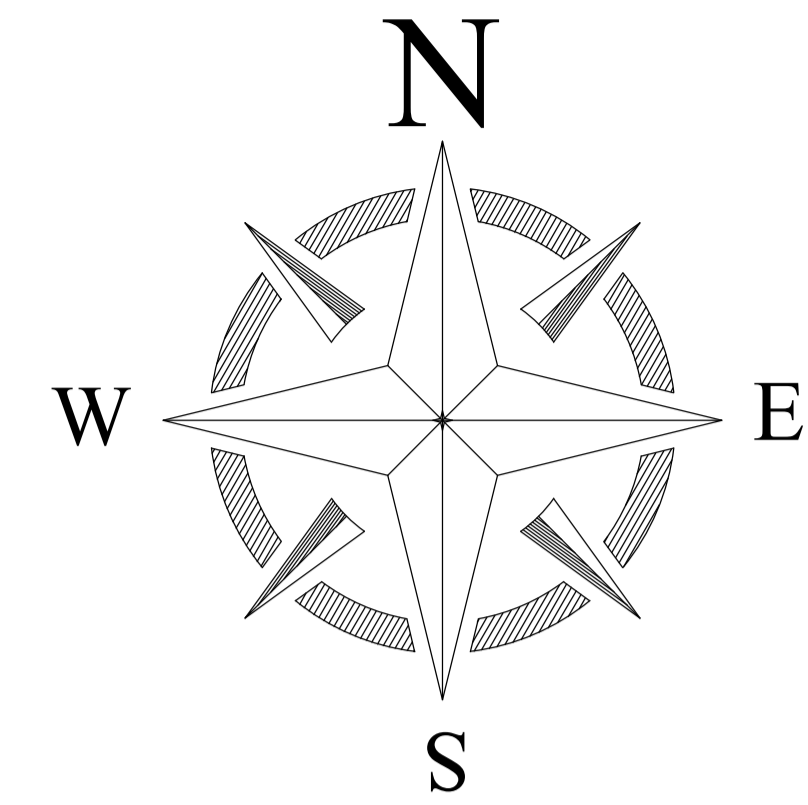

## SECONDARY SECTION

BLOCK NO	BLOCK NAME	AREA(In m)	TYPE
1	BLOCK - A	156.4	G. FLOOR
2	BLOCK - B	289.8	G+1 FLOOR
3	BLOCK - C	144.9	G. FLOOR
4	BLOCK - D	149.4	G. FLOOR
5	KITCHEN	36.9	G. FLOOR
6	PUMP HOUSE	12.9	G. FLOOR

## HIGHER SECTION

BLOCK NO	BLOCK NAME	AREA(In m)	TYPE
1	BLOCK - A	371.5	G. FLOOR
2	BLOCK - B	484.0	G+1FLOOR
3	BLOCK - C	206.3	G. FLOOR
4	BLOCK - D	462.0	G+1FLOOR
5	TOILET 1	8.4	G. FLOOR
6	TOILET 2	8.4	G. FLOOR
7	TOILET 3	8.4	G. FLOOR

CONSULTANT :



MaRS Planning & Engineering Services Pvt. Ltd.  
287/C Yash Padm Beside Hill Top Motors Ashok Nagar,  
Ranchi- 834002, Jharkhand, India.  
Jharkhand@marsconsultancy.com

TITLE : -A N S +2 HIGH SCHOOL RELIGARA

BLOCK : DARI

FORWARDED BY : MaRS