

# PROPOSED SITE PLAN OF SCHOOL

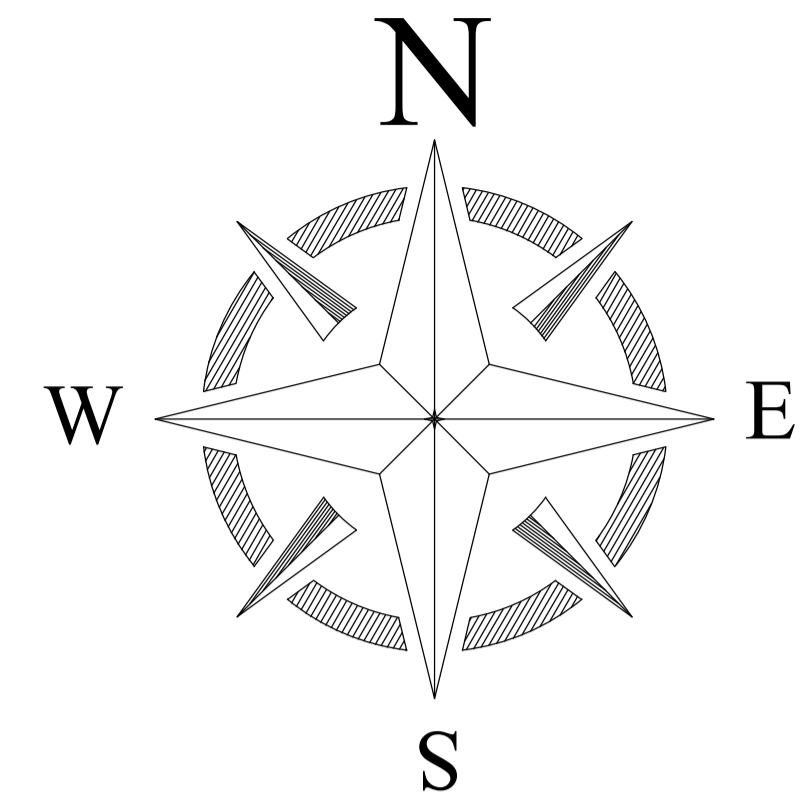

## LEGENDS

BLOCK NO	BLOCK NAME	AREA(In M)	TYPE
1	BLOCK - A	116 SQM	G +1
2	BLOCK - B	185 SQM	G FLOOR
3	BLOCK - C	370 SQM	G +1
4	BLOCK - D	578 SQM	G +1
5	BLOCK - E	370 SQM	G +1
6	BLOCK - F	154 SQM	G FLOOR
7	TOILET	25 SQM	

PRODUCED BY AN AUTODESK STUDENT VERSION

PRODUCED BY AN AUTODESK STUDENT VERSION

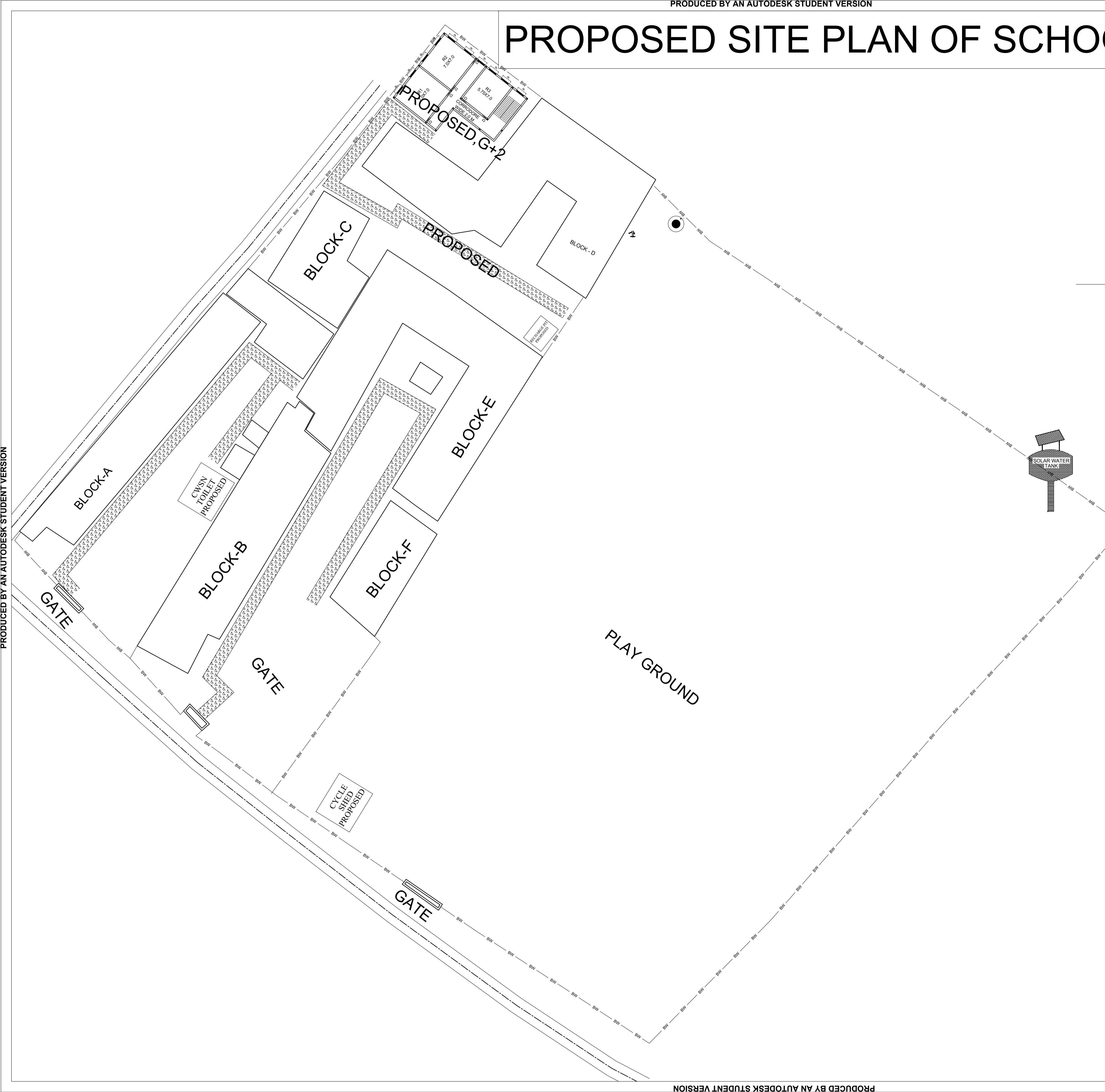

CONSULTANT : **MaRS** Planning & Engineering Services Pvt. Ltd.  
 287/C Yash Padm Beside Hill Top Motors Ashok Nagar,  
 Ranchi- 834002, Jharkhand, India.  
[Jharkhand@marsconsultancy.com](mailto:Jharkhand@marsconsultancy.com)

TITLE : - GOVT. CH+2 HS JHUMARI TELAIYA  
 BLOCK : KODERMA  
 FORWARDED BY : MaRS