

PROPOSED SITE PLAN OF SCHOOL

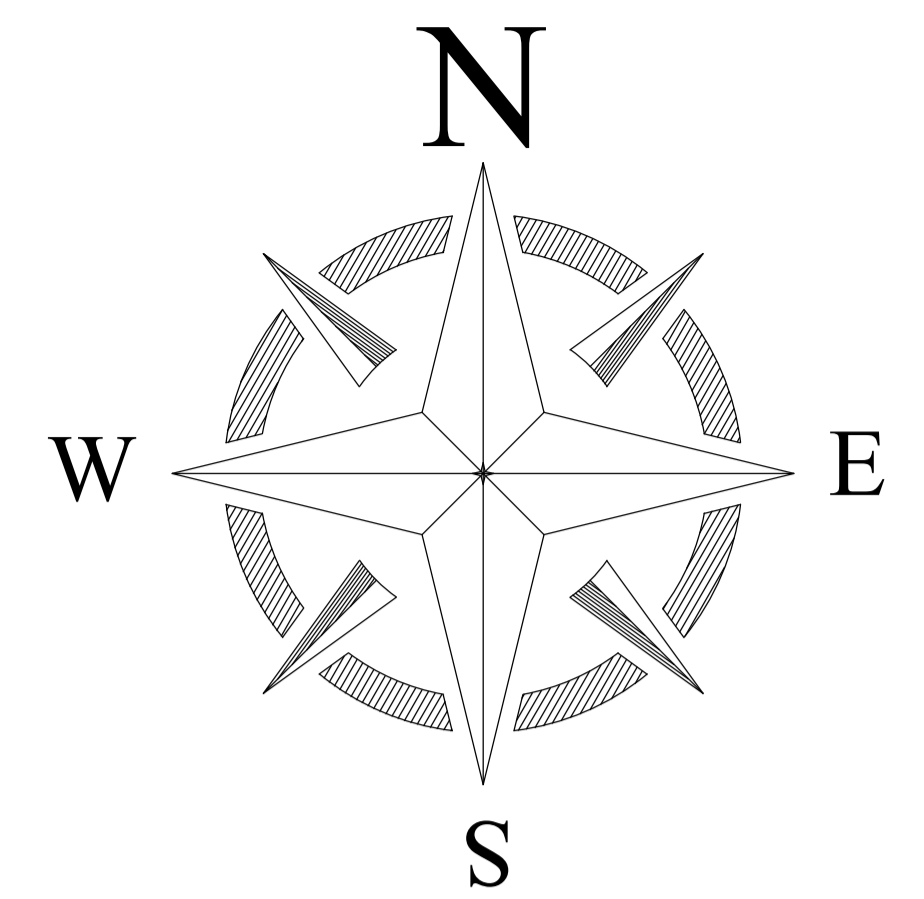

BLOCK NO	BLOCK NAME	AREA(In M)	TYPE
1	BLOCK - A	374.83 SQM	G FLOOR
2	BLOCK - B	256.20 SQM	G FLOOR
3	BLOCK- C	201.87 SQM	G FLOOR
4	BLOCK- D	65.84 SQM	G FLOOR
5	BLOCK- E	322.98 SQM	G FLOOR
6	BLOCK- F	322.98 SQM	G FLOOR
7	G. TOILET	22.44 SQM	G FLOOR
8	B. TOILET	22.44 SQM	G FLOOR
9	TOILET-1	23.47 SQM	G FLOOR
10	TOILET-2	15.02 SQM	G FLOOR
TOTAL AREA		15456.5592 SQM.	

CONSULTANT :

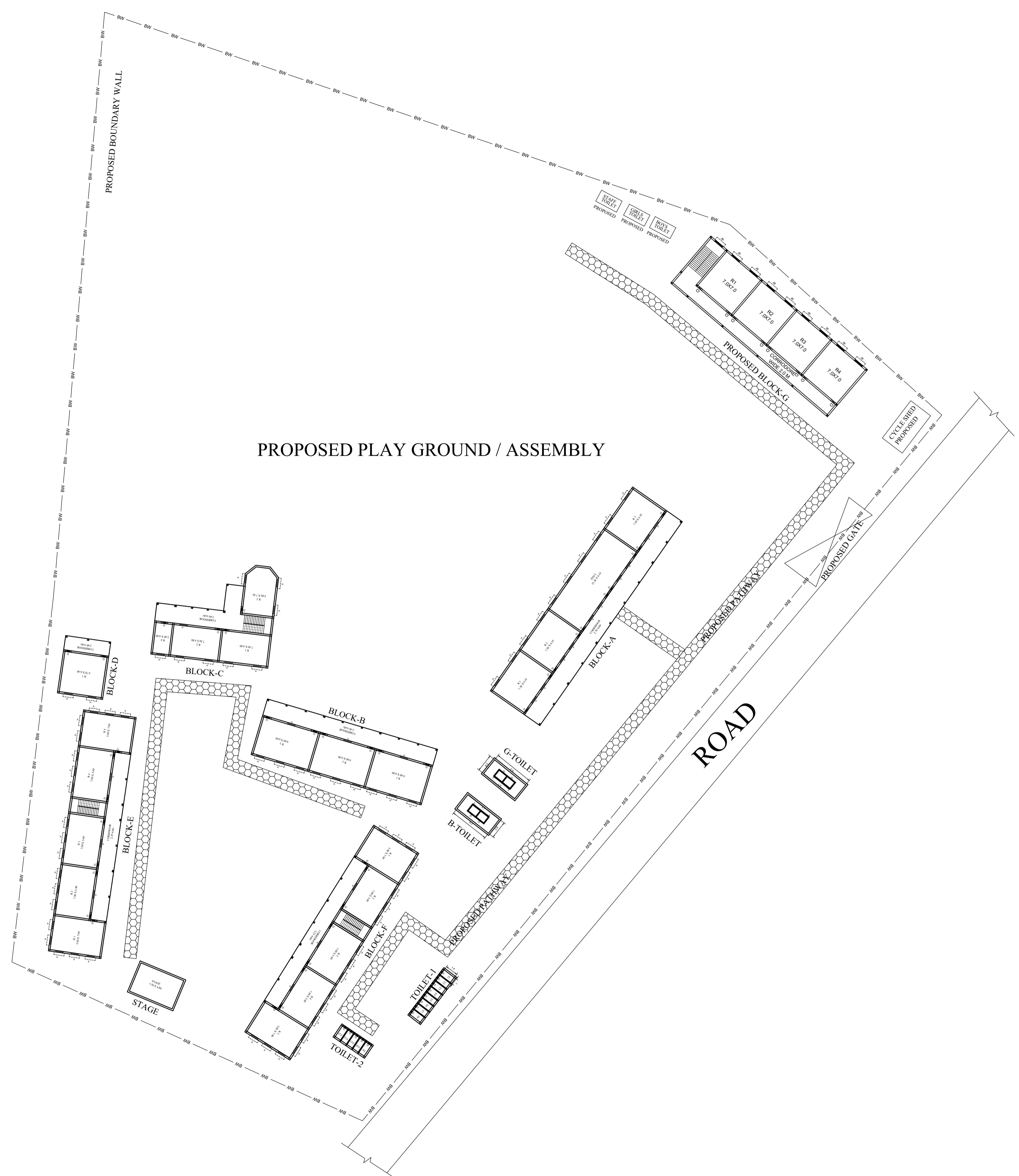

MaRS Planning & Engineering Services Pvt. Ltd.
 287/C Yash Padm Beside Hill Top Motors Ashok Nagar,
 Ranchi- 834002, Jharkhand, India.
Jharkhand@marsconsultancy.com

SCHOOL NAME : SMT .ANARKALI +2 H.S PALOJORI

DISTRICT : -DEOGHAR	PAGE : A4
BLOCK : -PALOJORI	
FORWARDED BY : MaRS	