

**PROPOSED SITE PLAN OF SCHOOL**

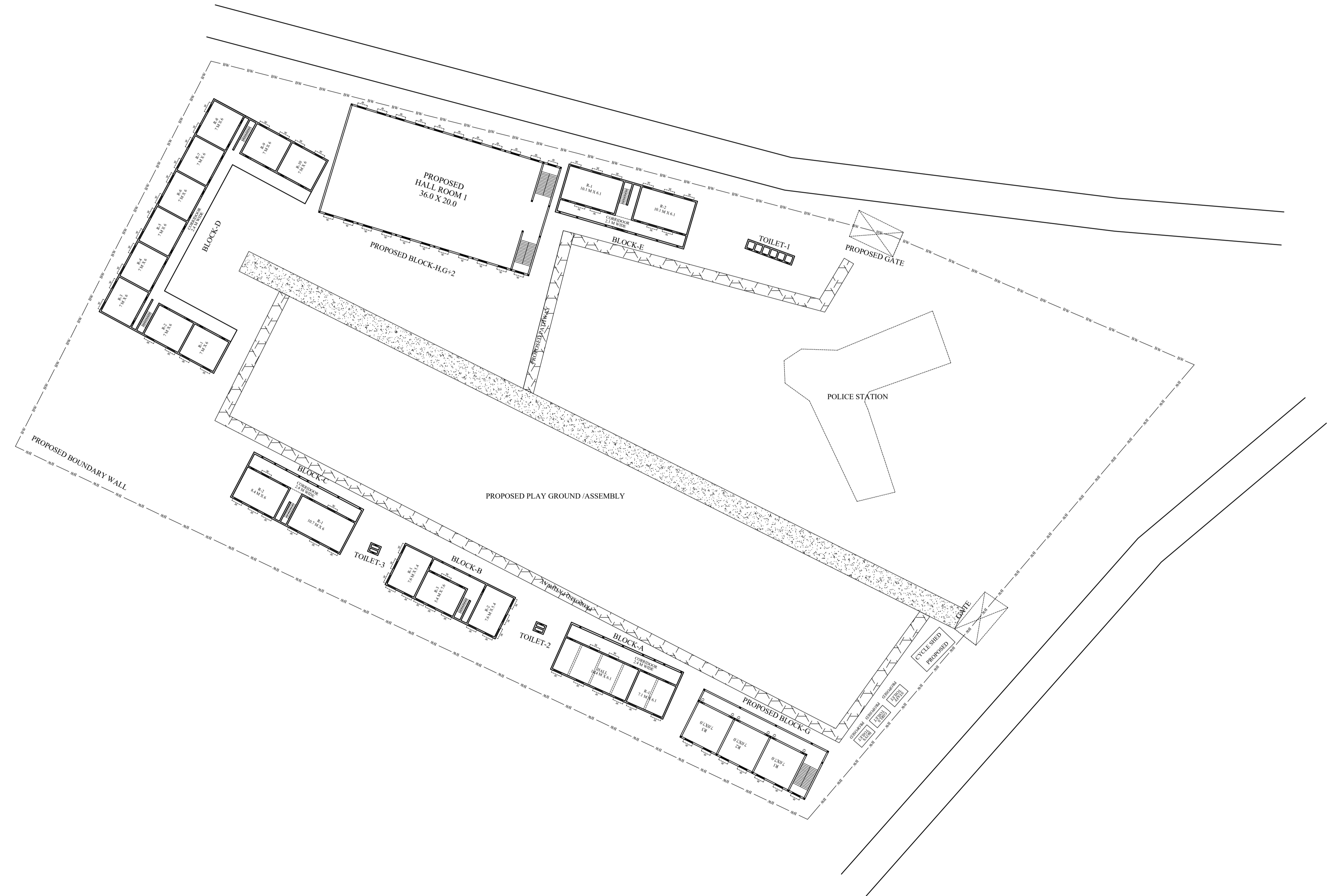
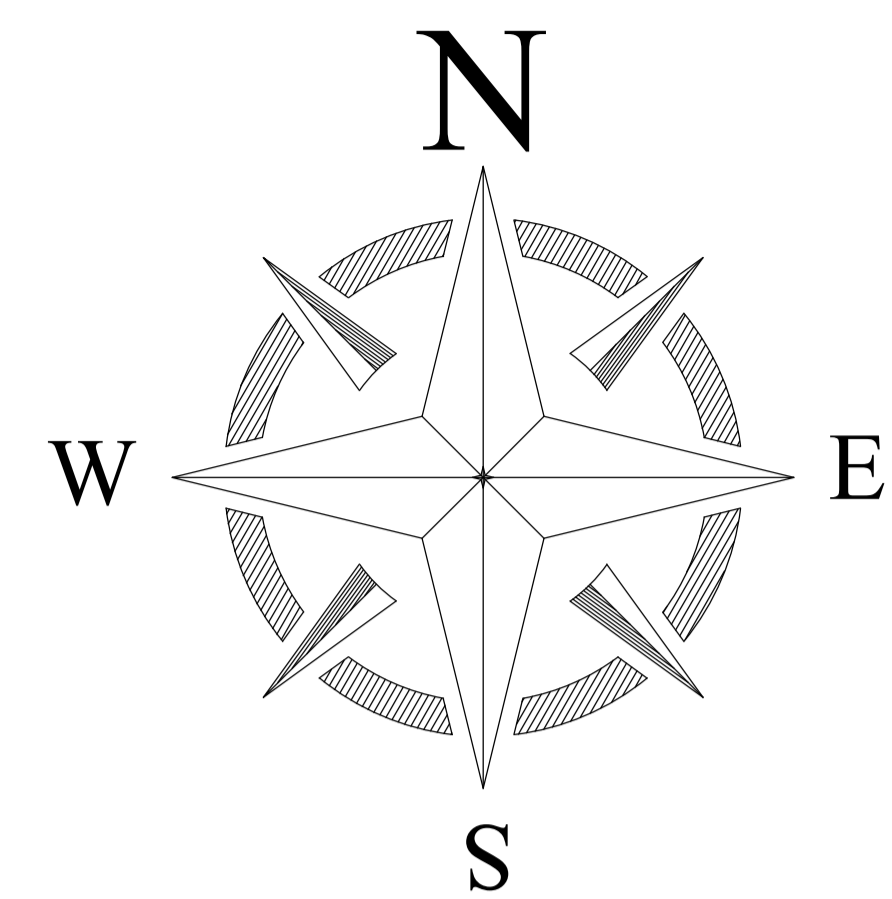

**GROUND FLOOR**

BLOCK NO	BLOCK NAME	AREA(In M)	TYPE
1	BLOCK - A	206.92 SQM.	G FLOOR
2	BLOCK - B	185.37 SQM.	G FLOOR
3	BLOCK- C	206.08 SQM.	G FLOOR
4	BLOCK- D	643.65 SQM.	G FLOOR
5	BLOCK- E	236.12 SQM.	G FLOOR
<b>TOTAL AREA</b>		<b>16022.9919 SQM.</b>	

CONSULTANT :



**MaRS Planning & Engineering Services Pvt. Ltd.**  
 287/C Yash Padm Beside Hill Top Motors Ashok Nagar,  
 Ranchi- 834002, Jharkhand, India.  
[Jharkhand@marsconsultancy.com](mailto:Jharkhand@marsconsultancy.com)

**SCHOOL NAME : R.K.H.S SARSA**

DISTRICT : -DEOGHAR

BLOCK : -PALOJORI

FORWARDED BY : MaRS