

# PROPOSED SITE PLAN OF SCHOOL

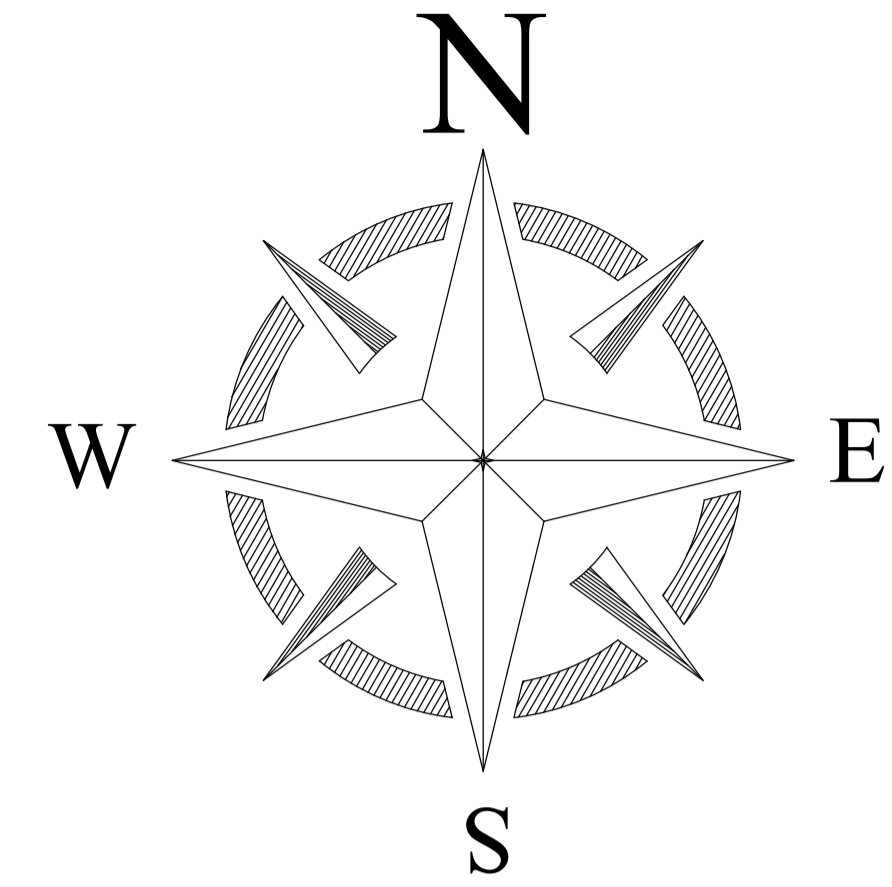

## MIDDLE SCHOOL CAMPUS

## PLAY GROUND

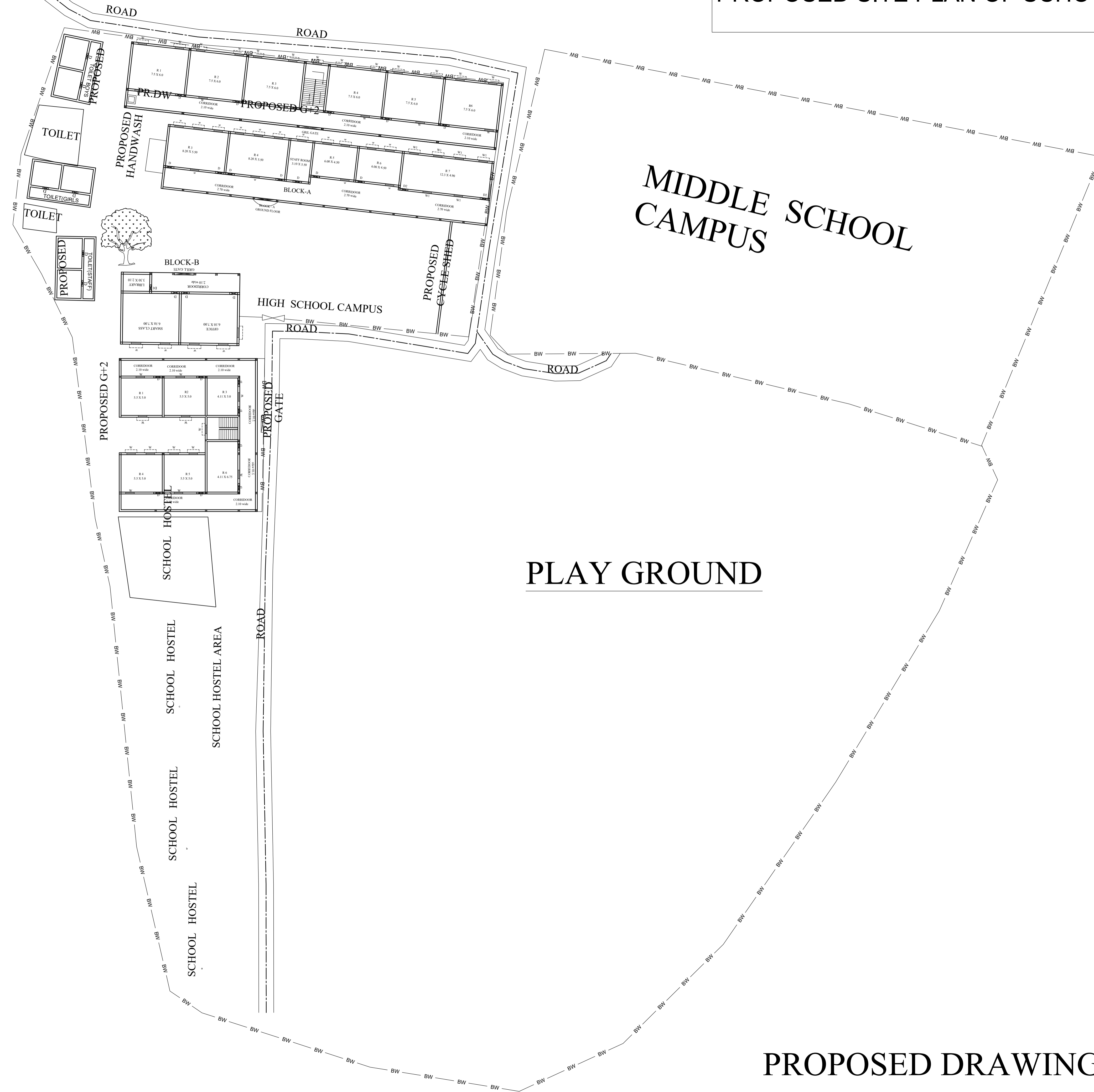

### LEGENDS

BLOCK NO	BLOCK NAME	AREA(In M)	TYPE
1	BLOCK - A	509.25 SQM	G FLOOR
2	BLOCK - B	132.02 SQM	G FLOOR
3	TOILET-1	7.65 SQM	G FLOOR
4	TOILET-2	23.31 SQM	G FLOOR

CONSULTANT :



**MaRS Planning & Engineering Services Pvt. Ltd.**  
 287/C Yash Padm Beside Hill Top Motors Ashok Nagar,  
 Ranchi- 834002, Jharkhand, India.  
[Jharkhand@marsconsultancy.com](mailto:Jharkhand@marsconsultancy.com)

**SCHOOL NAME : GOVT H.S BASANTRAI**

DISTRICT : -GODDA

BLOCK : - BASANTRAI

FORWARDED BY : MaRS

PAGE : A4

## PROPOSED DRAWING