

PROPOSED SITE PLAN OF SCHOOL

PROPOSED BUILDING

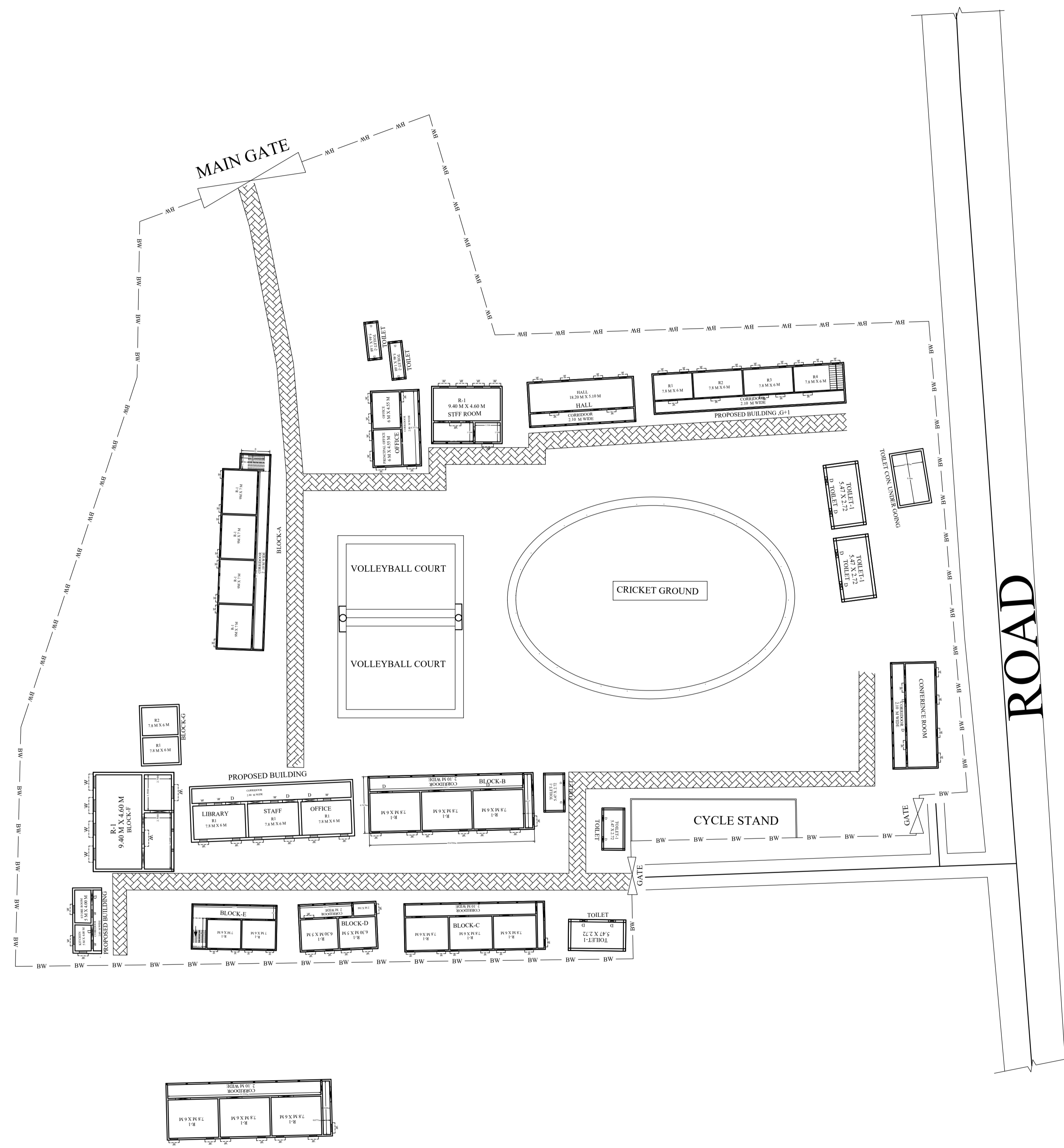

TOTAL LAND AREA -8982

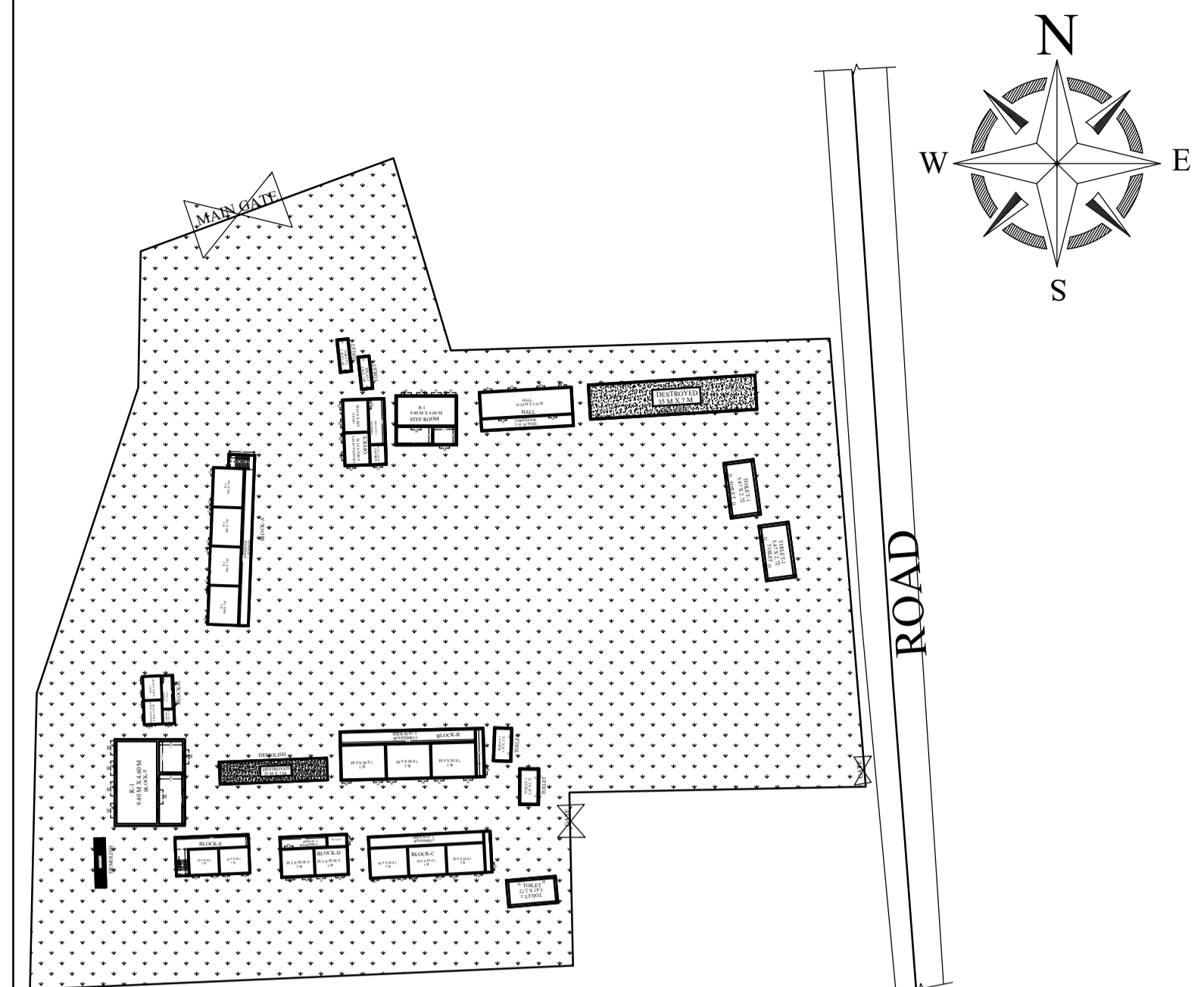

KEY PLAN

LEGENDS

BLOCK NO	BLOCK NAME	AREA(In sqm)	TYPE
1	BLOCK - A	387.5	G.+1 FLOOR
2	BLOCK - B	228.3	G. FLOOR
3	BLOCK - C	228.3	G.+1 FLOOR
4	BLOCK - D	98.8	G. FLOOR
5	BLOCK - E	168.2	G. FLOOR
6	BLOCK - F	69.3	G. FLOOR
7	BLOCK - G	103.2	G. FLOOR
8	TOILET-1	12.9	G. FLOOR
9	TOILET-2	12.9	G. FLOOR
10	TOILET-3	12.9	G. FLOOR
11	TOILET-4	12.9	G. FLOOR
12	TOILET-5	12.9	G. FLOOR
13	TOILET-6	12.9	G. FLOOR
14	TOILET-7	12.9	G. FLOOR
15	TEACHER SADAN	79.9	G. FLOOR
16	HALL	148.6	G. FLOOR
17	OFFICE	103.2	G. FLOOR
18	DESTROYED	266.2	G. FLOOR
19	TOILET CON. UNDER GOING	59.82	G. FLOOR

CONSULTANT :



MaRS Planning & Engineering Services Pvt. Ltd.
 287/C Yash Padm Beside Hill Top Motors Ashok Nagar,
 Ranchi- 834002, Jharkhand, India.
Jharkhand@marsconsultancy.com

SCHOOL NAME : SRI N.N. HIGH SCHOOL BAGSUMA

DISTRICT : - DHANBAD	PAGE : A3
BLOCK : -GOVIND PUR	
FORWARDED BY : MaRS	