

# +2 HIGH SCHOOL CHANDANKIYARI

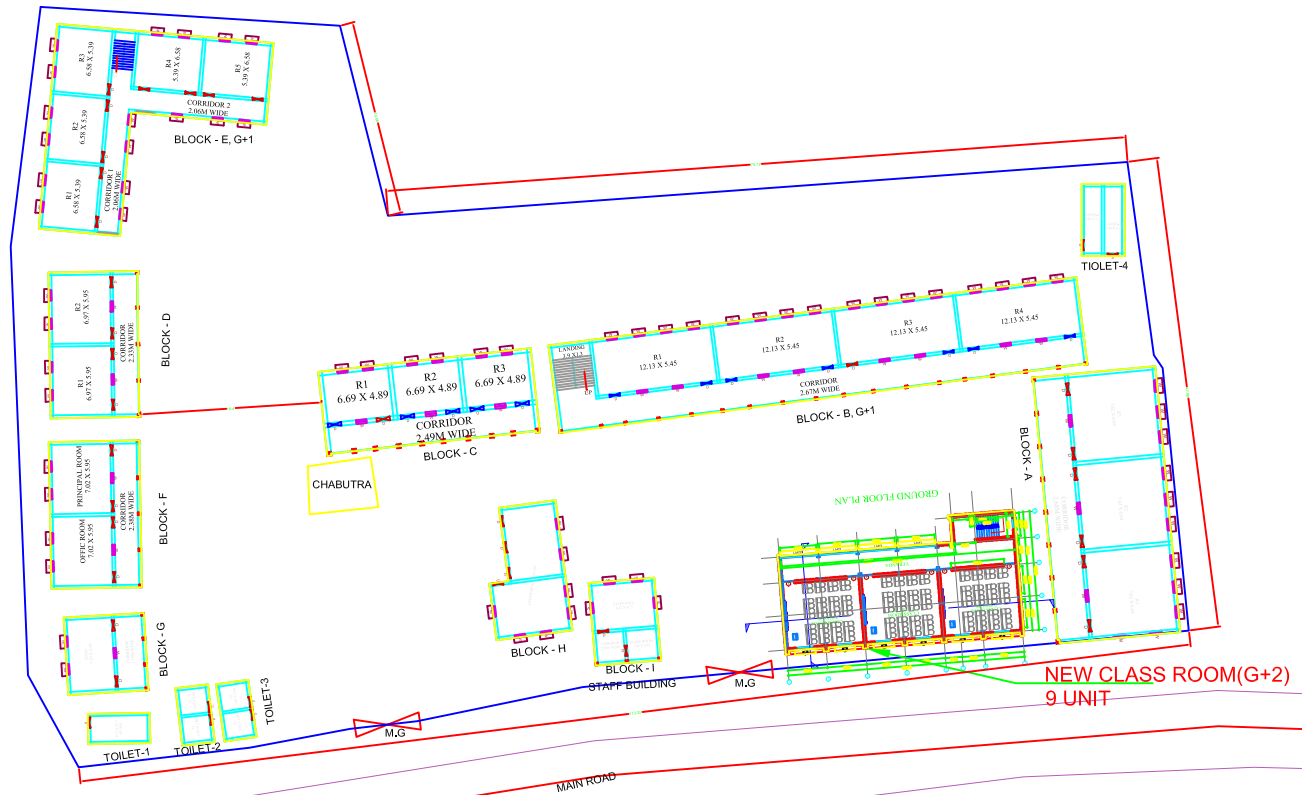
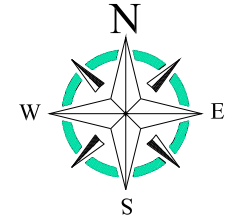

TOTAL LAND AREA-6524.3 SQM

## LEGENDS

BLOCK NO	BLOCK NAME	AREA(In m)	TYPE
1	BLOCK - A	263.7	G. FLOOR
2	BLOCK - B	960	G+1 FLOOR
3	BLOCK - C	182.2	G. FLOOR
4	BLOCK - D	133.1	G. FLOOR
5	BLOCK - E	573.4	G+1 FLOOR
6	BLOCK - F	136.4	G. FLOOR
7	BLOCK - G	64.0	G. FLOOR
8	BLOCK - H	88.5	G. FLOOR
9	BLOCK - I	55.9	G. FLOOR
10	TOILET - 1	19.4	G. FLOOR
11	TOILET - 2	19.4	G. FLOOR
12	TOILET - 3	19.4	G. FLOOR
13	TOILET - 4	31.9	G. FLOOR

CONSULTANT :

MaRS Planning & Engineering Services Pvt. Ltd.  
287/C Yash Padm Beside Hill Top Motors Ashok Nagar,  
Ranchi- 834002, Jharkhand, India.  
[Jharkhand@marsconsultancy.com](mailto:Jharkhand@marsconsultancy.com)



SCHOOL NAME : - +2 H.S CHANDANKIYARI (BOKARO)

DISTRICT : - BOKARO BLOCK : - CHANDANKIYARI

FORWARDED BY : MaRS