

PROPOSED SITE PLAN OF SCHOOL

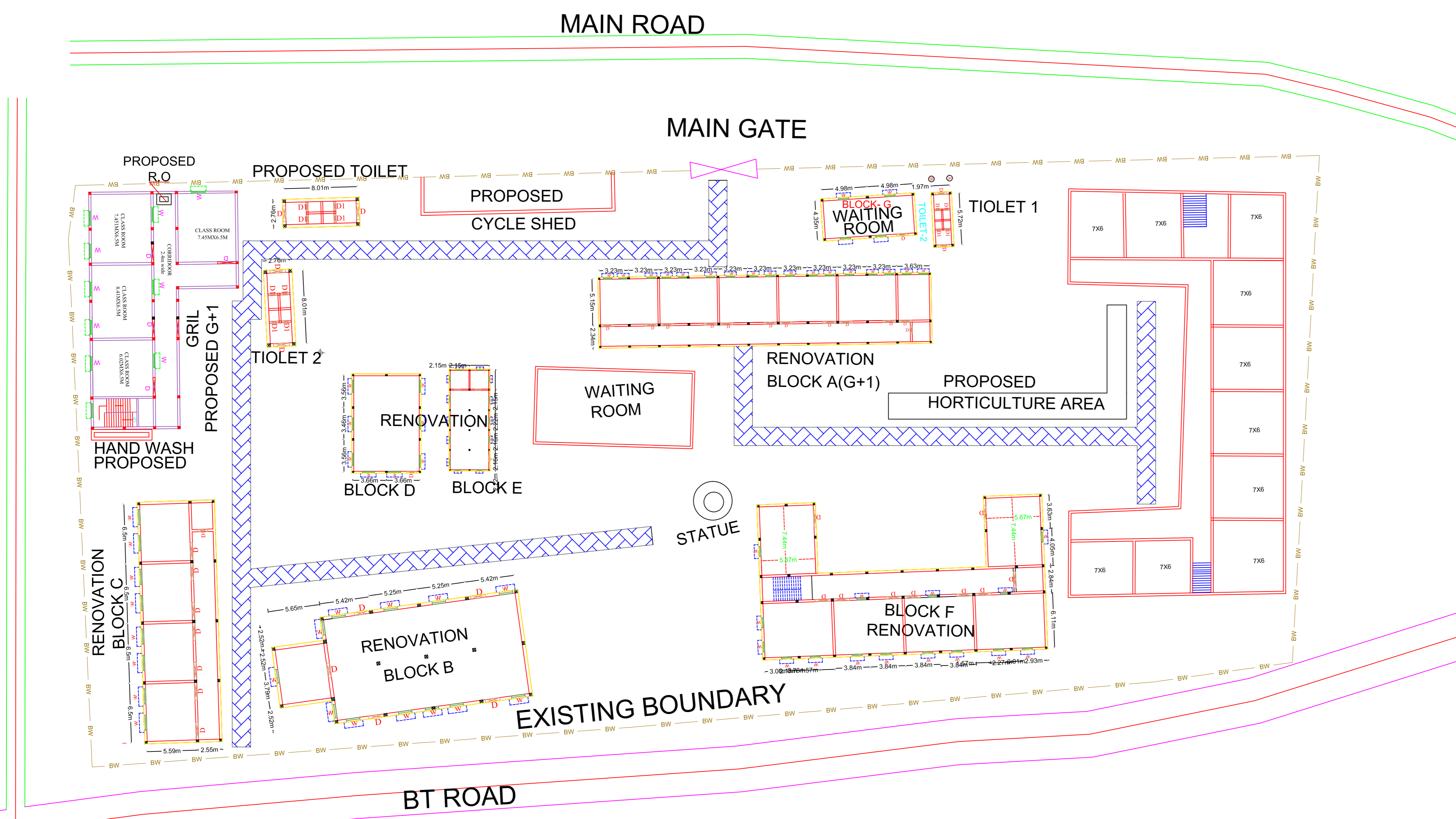
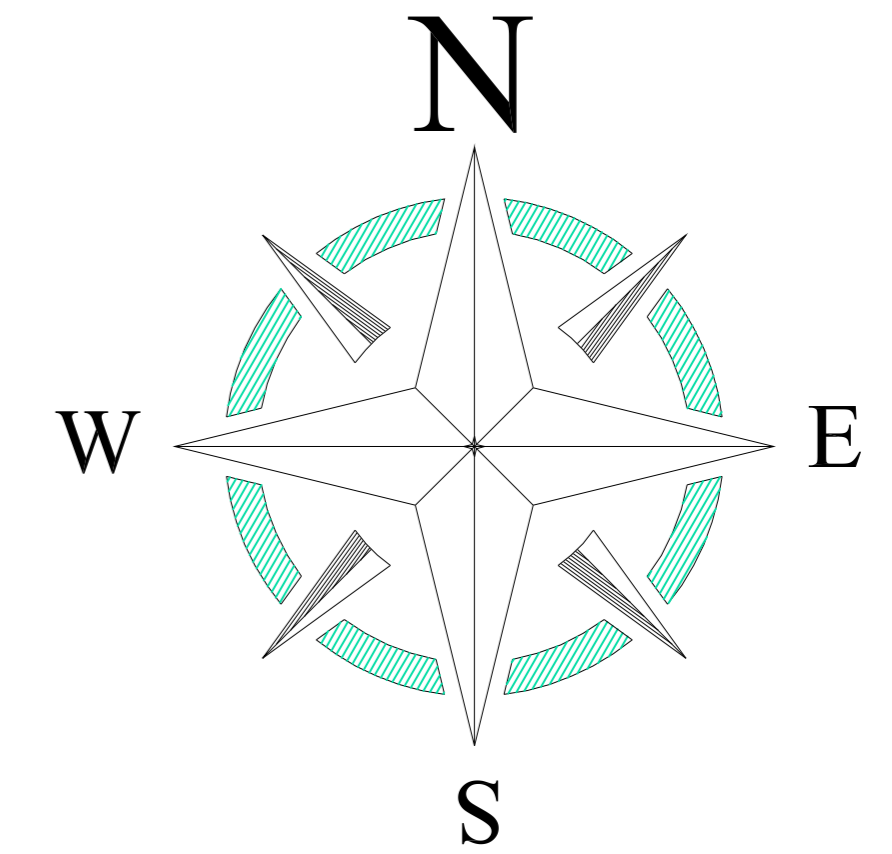

BLOCK NO	BLOCK NAME	AREA(In m)	TYPE
1	BLOCK - A	797.4	G+1 FLOOR
2	BLOCK - B	164.6	G.FLOOR
3	BLOCK - C	194.4	G .FLOOR
4	BLOCK - D	110.7	G .FLOOR
5	BLOCK - E	190.7	G. FLOOR
6	BLOCK - F	399.5	G. FLOOR
7	BLOCK - G	46.9	G. FLOOR
8	BLOCK - NEW	738.34	G.+1FLOOR
9	TOILET-1	16.38	G. FLOOR
10	TOILET-2	16.38	G. FLOOR

CONSULTANT :  
 MaRS Planning & Engineering Services Pvt. Ltd.  
 287/C Yash Padm Beside Hill Top Motors Ashok Nagar,  
 Ranchi- 834002, Jharkhand, India.  
[Jharkhand@marsconsultancy.com](mailto:Jharkhand@marsconsultancy.com)

SCHOOL NAME :RAMVILAS +2 HIGH SCHOOL BERMO

DISTRICT : - BOKARO	PAGE : A1
BLOCK : - BERMO	
FORWARDED BY : MaRS	

PROPOSED DRAWING.  
 TOTAL LAND AREA-8041.53 SQM